



Element 5 Mallorca S.L.U.
Home Development & Real Estate

www.element5mallorca.com
info@element5mallorca.com
Mob. + 34 620 160 408
Tel. + 34 971 770 111

FANTASTIC NEW COUNTRY HOUSE WITH SEA VIEWS NEAR SANTANYÍ

#727



EUR 2,950,000



400m²



5



4



21,800m²





Element 5 Mallorca S.L.U.
Home Development & Real Estate

www.element5mallorca.com
info@element5mallorca.com
Mob. + 34 620 160 408
Tel. + 34 971 770 111

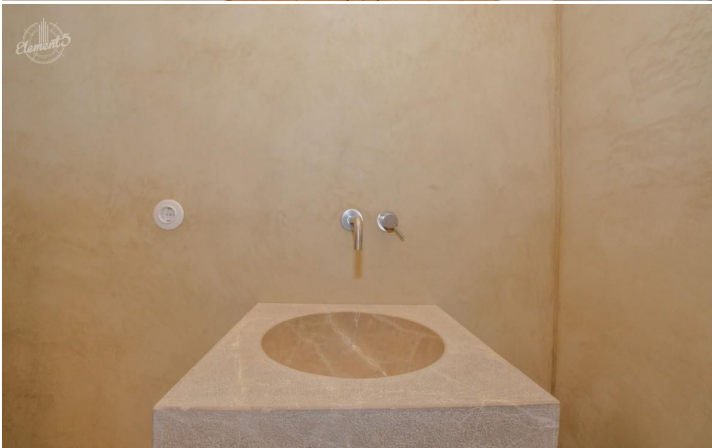



Element 5 Mallorca S.L.U.
Home Development & Real Estate

www.element5mallorca.com
info@element5mallorca.com
Mob. + 34 620 160 408
Tel. + 34 971 770 111

Main

Construcción	Country house
Brand new	✓
Year of construction	appr. 2020
Location	Santanyí
Plot size	appr. 21800m ²
Built-over area	appr. 400m ²
Bedrooms	5
Bathrooms	4
Bathrooms en suite	3
Type of parking space	Open space
Energy certificate	
Outdoor kitchen	✓
BBQ	✓
Laundry room	✓
Cloak room	✓

Equipment

The house was built using the highest quality materials. Particular emphasis was placed on authenticity and living comfort. Only warm natural tones were used for the expansion; the walls were kept in a pleasant lime plaster and a rustic natural stone floor was laid in a Roman compound in combination with earthenware tiles. The harmoniously integrated design kitchen, which was designed and built by a German carpenter and leaves nothing to be desired, is certainly outstanding. The bathrooms are fitted with "Iconico" fittings. The entire house is equipped with underfloor heating and the bedrooms have appropriate air conditioning. There are also high-quality wooden windows with wooden Persiana, a guest toilet, a wooden pergola, a large pool with pool house and pool toilet, storage room and BBQ area.

Electricity	Public
Water	Own water supply
Heating system	Floor heating
Combustible	Air-water heat pump
Safety features	Alarm system
Double glazing	✓
Automatic irrigation	✓
Full equipped kitchen	✓
TV	✓
Telephone	✓
Internet	✓

Location

The property is only a few minutes from the town center, between Santanyí and Cala Llombards. Absolute peace in a Mediterranean environment invites you to relax.

Location	Rural
Topography	Flat
Views	Panoramic view, Sea, Landscape view, Garden, Surroundings
Views towards	South